

PNÖMATİK YÖN DENETİM VALFİ

PNEUMATIC DIRECTIONAL CONTROL VALVE

ELECTRICALLY ACTUATED VALVES BOBİNLİ VALFLER



NMSV - . . . - . -

Ölçü / Connection
G 1/8"
G 1/4"

Yol Sayısı Number of ways
5

Konum Sayısı Number of positions
2

Geri Geliş Şekli Return Actuation Type
B Bobin / Solenoid
Y Yay / Mechanical spring

Bobin Tipi Solenoid Type
Y Yatık / Horizontal

Bobin Gerilimi Voltage Type
12 V DC
24 V DC
24 V AC
110 V AC
220 V AC

Uyarı Şekli Actuation Type
B Bobin / Solenoid

TEKNİK ÖZELLİKLER / TECHNICAL SPECIFICATIONS

Çalışma Basıncı / Operating Pressure Range : 1-3 . . . 10 bar



Debi / Flow Rate (6 bar) G 1/8" : 600 NI / dak.

Debi / Flow Rate (6 bar) G 1/4" : 990 NI / dak. / NI/min.

Çalışma sıcaklığı / Temperature Range : -10 . . . +80 °C

Çalışma ortamı / Medium

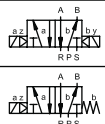
: Filtre edilmiş kuru ve yağlı hava / Lubricated or unlubricated filtered compressed air.

Simge / Symbol	Tip / Type	Çalışma Basıncı (bar) Operating Pressure Range (bar)	Ağırlık (g) Weight (g)
	NMSV-1/4-5/2-B-B-Y	1....10	490
	NMSV-1/4-5/2-B-Y-Y	3....10	360

Yatık Bobinli Namur Gövdeli Valf

Horizontal type solenoid namur body

NMSV-1/4-5/2-B-Y-Y

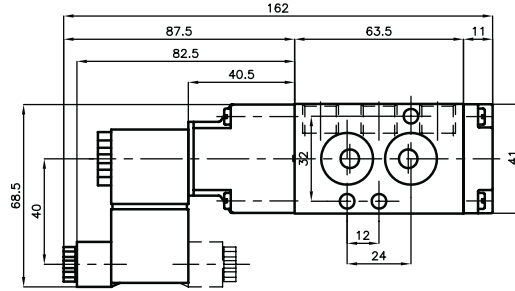

NMSV-1/4-5/2-B-B-Y

